

Cleburne Sheet Metal

A full line of roof, wall, sun shade, edge metal and interior cladding products, fabricated and installed by one of the premier architectural & structural metal manufacturing firms in the United States

Aluminum Composite Panel Systems (ACM)
Roof & Wall Systems | Sun Shade Air Foil System
Extreme Force Parapet Cap | Column Covers



**Cleburne
Sheet
Metal**

Unlimited
Design
Possibilities

Welcome to Cleburne Sheet Metal

Cleburne Sheet Metal is a privately held corporation specializing in the fabrication and installation of high end architectural sheet metal goods for both the commercial and residential construction industries. Since its inception in 1986, Cleburne Sheet Metal has grown to become one of the premier architectural and structural metal roofing companies in the United States.

Scope of Work:

Cleburne Sheet Metal has completed more than 1500 projects over the past twenty years. Projects range from small residential retrofits to historical renovations of some of Texas's most prestigious court houses. Commercial projects range from fast food restaurants to the most luxurious hotels and resort properties in North America.

Commitment to Quality and Client Satisfaction:

Our personal commitment to our clients has been one of the most important factors behind our success. The lifetime relationships that we've established serve as testimony to our commitment to quality and service.

Products:

- Aluminum Composite Panels (ACM)
- Architectural Roof Panels
- Fascia, Wall & Soffit Panels
- Sunshade Airfoil Systems
- Extreme Force Parapet Cap System
- Column Covers
- Aluminum Louvers

Equipment & Manufacturing Capabilities:

- A Full Line of Precision-Tolerance Mobile Roll Formers for Roof & Wall Panels
- State of the Art Aluminum Composite ACM Manufacturing
- A Fleet of Trucks and Lifting Equipment

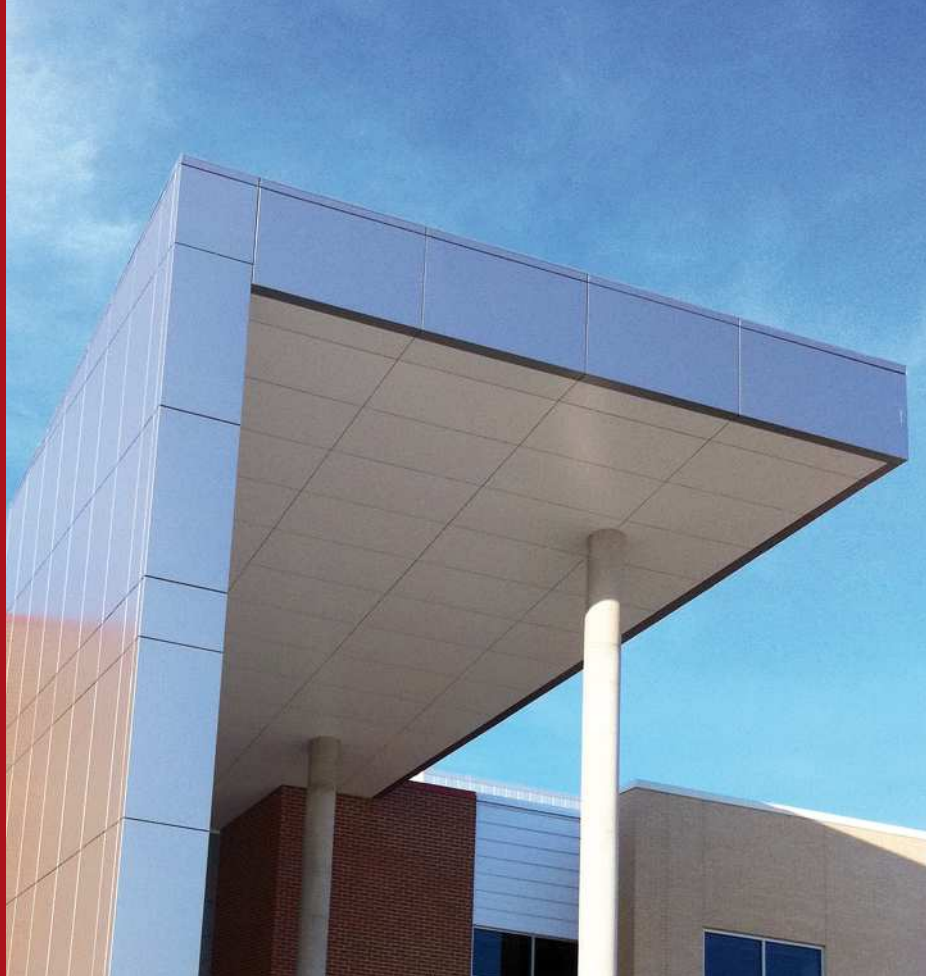



Staff and Capabilities:

Our staff consists of professionals experienced in estimating, drafting and design, project management, scheduling, and field supervision. We will work with your design team from inception to completion to insure that the right product is selected and that design integrity is maintained. Our team of professionals has over 150 years of experience in all types of construction.

Manufacturing & Installation:

Cleburne Sheet Metal owns its own precision-tolerance roll forming equipment to fabricate architectural roofing, siding and soffit systems. We have the capability to form roofing panels in continuous lengths to eliminate endlaps and leak-prone fasteners.

Our state-of-the art, climate-controlled ACM manufacturing facility houses the latest in computer-aided Aluminum Composite Metal Panel fabrication equipment. We can also perform a wide range of performance tests in house.

Delivery & Installation:

Cleburne Sheet Metal owns its own trucks, cranes and lifts for delivery and installation. Our trained crews insure that each component is installed in accordance with approved details.

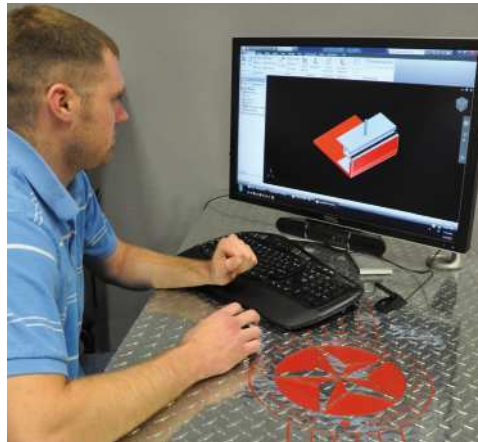

Aluminum Composite Metal (ACM) Panels: Designed, Fabricated & Installed to Meet Project Specifications



2400 Elite Series Panels

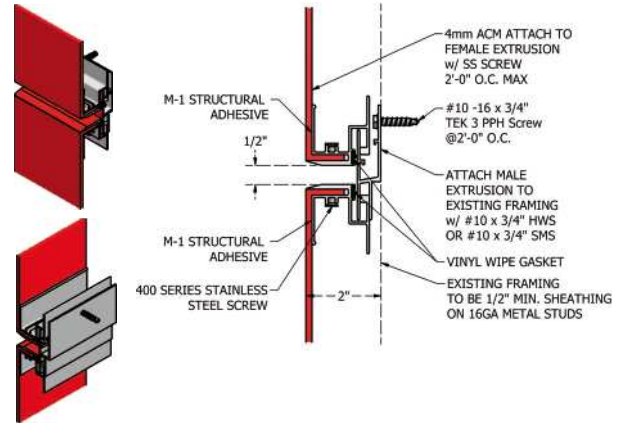

Rain Screen Dry Joint Systems

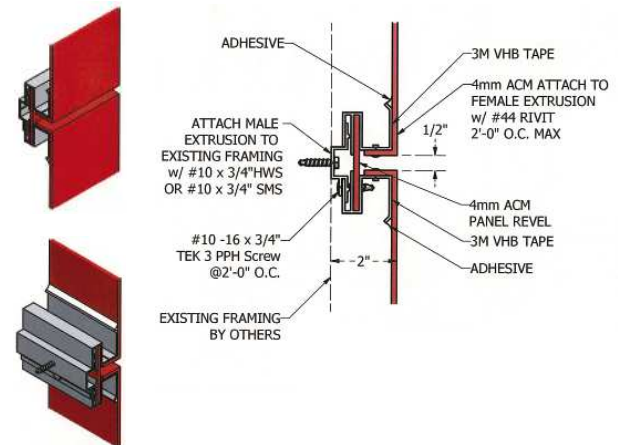

Rout & Return Wet Seal Systems

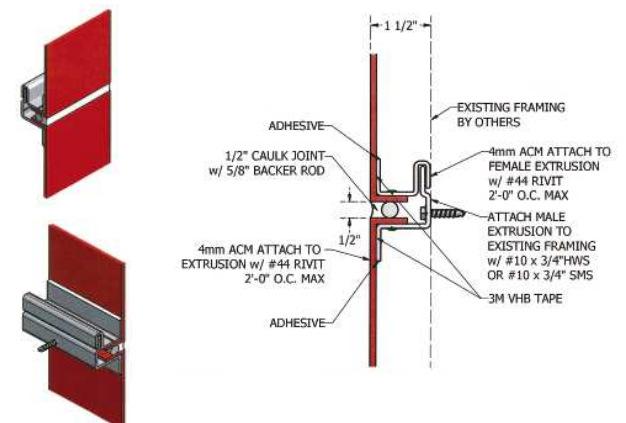

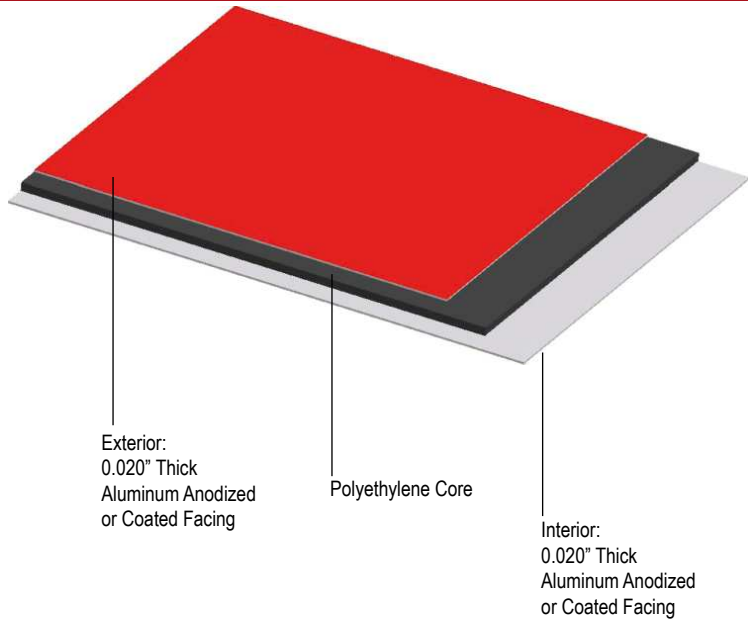

Physical Properties

Material Composition

- Aluminum facings in 0.020" nominal thickness (interior and exterior to ensure flatness)
- Polyethylene core available in 3mm, 4mm, and 6mm thicknesses (PE)
- Proprietary fire-resistant core available in 4mm thickness only (Plus)

Available Finishes

- PVDF
- Anodized
- Natural



Berridge Wall & Soffit Panels



Berridge HR-16 Panel



Horizontal or Vertical Wall Panels
Versatile, Maintenance-Free, Prefinished
Metal Wall Panels for Open Spans



Berridge Deep-Deck Panel



Multi-Purpose Structural Panel for
Roof, Deck, Wall, Soffit or Fascia
Applications

Berridge L- Panel



Soffit and Facade System,
Liner or Soffit Panels; Versatile,
Maintenance-Free,
Prefinished Metal Panels for Open
Spans



Berridge B-6 Panel

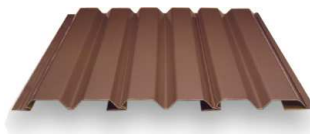

Wall or Soffit Panels for Open
Spans. Also Used for Facade,
Fascia or Ceiling

Berridge Vee-Panel



Wall, Soffit, Liner and Facade Panel,
Versatile, Maintenance-Free,
Prefinished Metal Panels for Open
Spans



Berridge Thin-Line Panel



Soffit and Facade System,
Liner or Soffit Panels; Versatile,
Maintenance-Free,
Prefinished Metal Panels for Open
Spans

The CSM Elite Wall & Soffit Panel Series: 12" or 16" Coverage Panels Designed to fit every need

CSM Elite Wall Panel Series

- 22 or 24 Gauge Berridge Kynar 500®
- Horizontal or Vertical Orientation
- Factory Mitered Corners Available
- Hidden Fasteners
- Multi-Purpose: Wall, Soffit, Liner or Equipment Screen
- Spans over Open Framing or Solid Sheathing with approved Underlayment
- 21' Maximum Panel Length



BB Elite Series



BR Elite Series



RB Elite Series



RR Elite Series



SB Elite Series

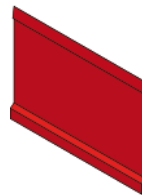

SR Elite Series

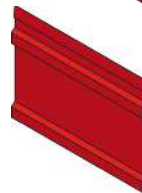

WR Elite Series



CR Elite Series

CSM Elite Soffit Panel Series

- 22 or 24 Gauge Berridge Kynar 500®
- Horizontal or Vertical Orientation
- Factory Mitered Corners Available on X2-12 Panel only
- Hidden Fasteners
- Multi-Purpose: Wall, Soffit, Liner or Equipment Screen
- Spans over Open Framing or Solid Sheathing with approved Underlayment
- 21' Maximum Panel Length



F-12 Elite Series



R-12 Elite Series



R.5-12 Elite Series



R1-12 Elite Series



R-6 Elite Series



R-4 Elite Series



FV-12 Elite Series

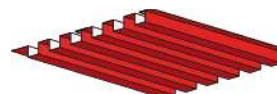

X2-12 Elite Series

We have the roof system to meet your design requirements

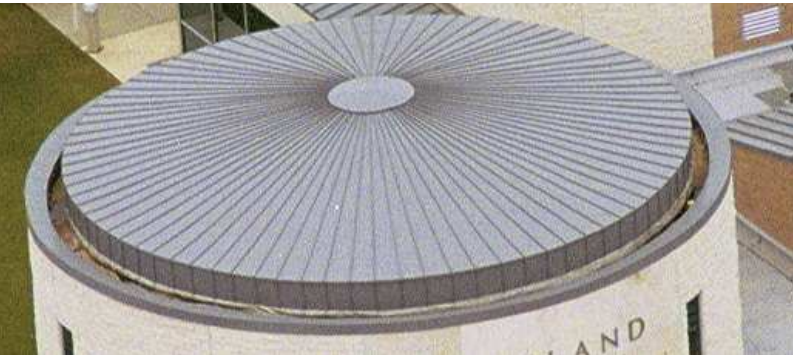

Berridge Tee-Panel



Straight, Curved or Tapered Metal Standing Seam

with exclusive patented vinyl weatherseal as an integral part of Snap-On Seam*. Prefinished or Satin Finish Galvalume; concave or convex, curved or compound curved corner and domed roof construction with solid sheathing

- Hidden fasteners
- Extruded vinyl weatherseal as integral part of Snap-On Seam* to prevent siphoning or flooding over seam
- Formed in Continuous lengths on CSM precision-tolerance mobile factory roll former
- Narrow seam
- U.L. 90 & U.L. fire resistance listed
- ASTM air & water tested

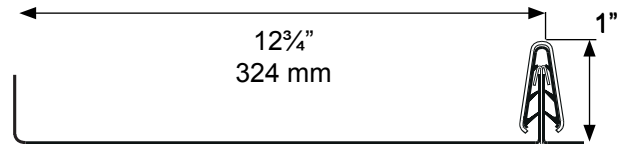

* U.S. Patent No. 4641475

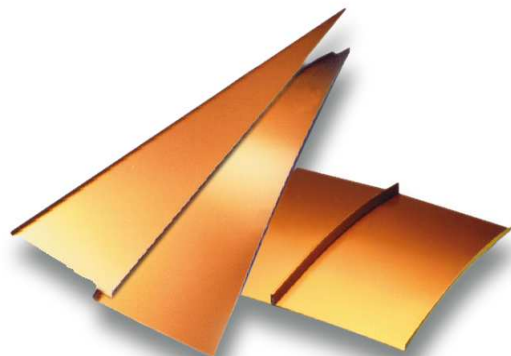

Berridge Zee-Lock

Architectural/Structural Standing Seam Roof System

For use over open purlin framing or solid sheathing

- Extruded patented* vinyl weatherseal strip
- Mechanically seamed sidelap
- 2" high standing seam sidelap
- U.L. 90 & U.L. fire resistance listed
- ASTM air & water resistance tested
- ASTM E-1592 tested
- Formed in Continuous lengths (straight or curved) on CSM mobile factory roll former
- FMRC Approved & 1-120 Rated
- May be Double-Lock Seamed
- Corps of Engineers CEGS 07416 approved
- Metro-Dade NOA Approved
- Florida Building Code Tested
- Optional Striations available

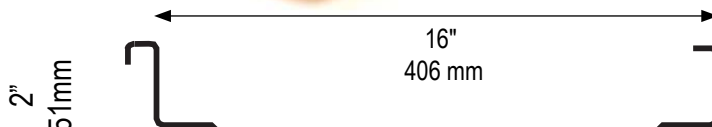

*Optional Extruded Vinyl Weatherseal (U.S. Patent No. 5134825)
Note: Vinyl Weatherseal required for open framing applications



Zee-Lock can be curved to a minimum radius of 20' using the CSM Curver machine. Both roll forming and curving of the panel may be done on-site.

Berridge Cee-Lock

Snap-Lock Standing Seam Roof

- Easy to install, integral Snap-Lock Seam
- U.L. 90 & U.L. fire resistance listed
- Hidden fasteners
- May be formed in Continuous length panels on CSM mobile factory roll former
- Patented* vinyl weatherseal (optional)
- ASTM air & water tested
- ASTM E1592 tested
- Metro-Dade NOA Approved
- Florida Building Code Tested

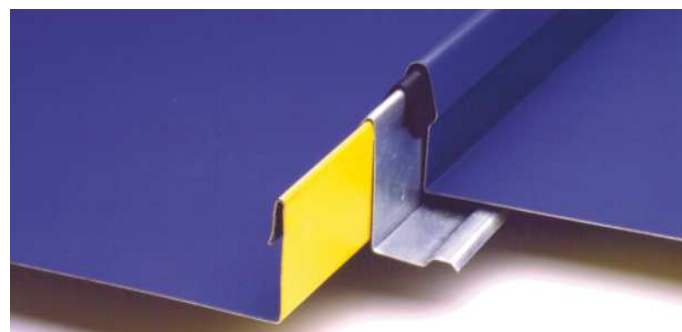
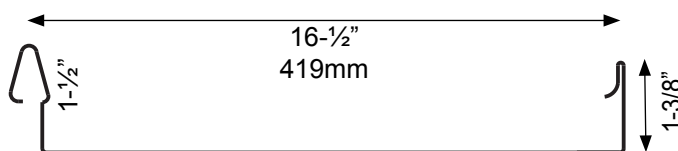

Integral Snap-Lock Seam with Patented Vinyl Weatherseal

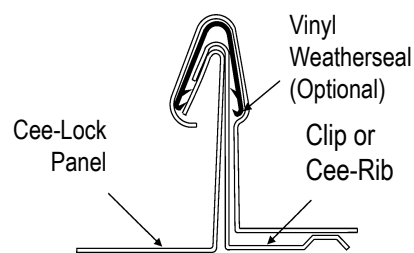

* U.S. Patent No. 4641475

CSM Column Covers: Clad with ACM for Superior Strength and Appearance

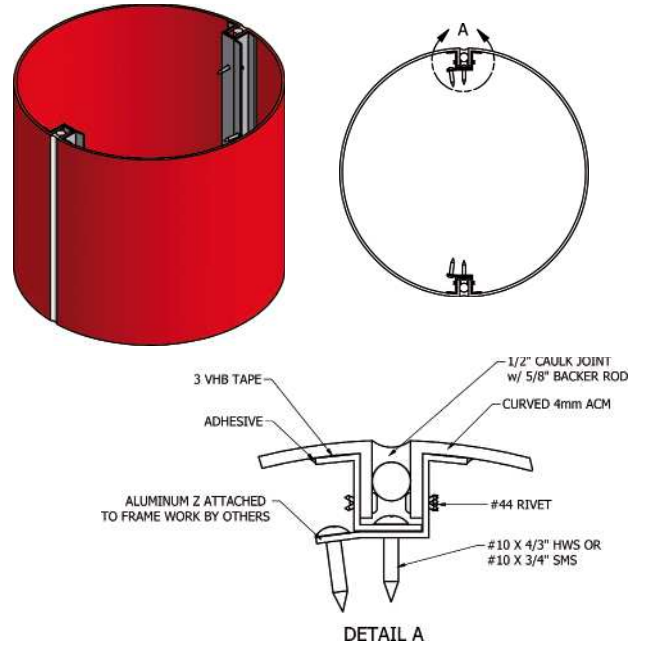

CSM Extreme Force Parapet Cap System: Superior Strength, Enhanced Appearance

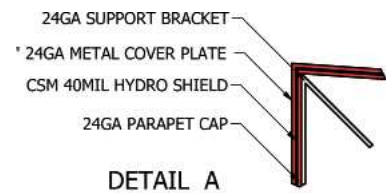
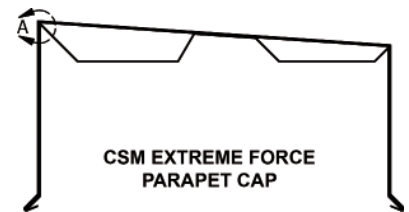
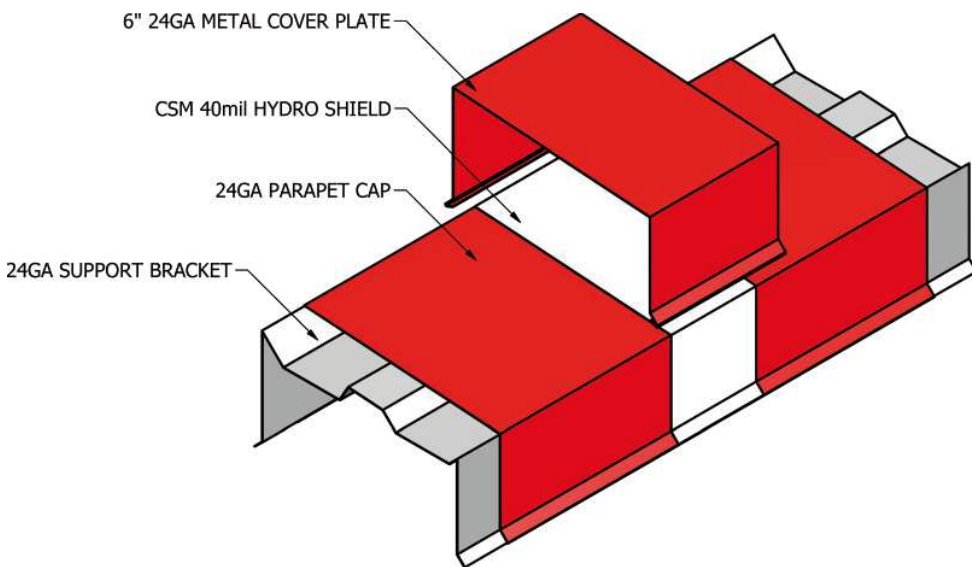

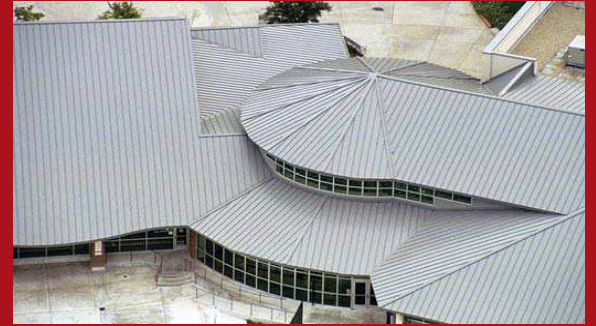

Cleburne Sheet Metal

CLEBURNE SHEET METAL
6432 Nine Mile Bridge Rd.
Fort Worth, TX 76135
T: (817) 237-5060
F: (817) 237-5191
cleburnesheetmetal.com